

**REPORT OF THE POLICE SERVICE
TO
THE CHATHAM-KENT POLICE SERVICES BOARD**

Board Report Number: 4.3 (Regular)

Date of Report: March 24, 2021

Date of Board Meeting: April 20, 2021

Reference: Replace Conference Equipment of CKPS Boardroom Audio Visual

Recommendations: Receive the report and approve funding from the COVID Provincial Relief Subsidy or IT Reserve

Since the start of COVID-19 the CKPS and most other organizations have moved to an online based conference style of meetings. Our existing online conference equipment and setup within the CKPS Boardroom was antiquated and outdated for our needs in the ever-changing technological landscape. The microphone efficacy has been an issue on several occasions and the projector and screen are not bright enough for the room.

In researching the needs of our service, and taking into account the increase in online activity, cyber security was a key component. With an influx of cyber-attacks, locally and provincially, the security of police training, conference calls and police board meetings, is vital to ensure police techniques, programs and networks are not hacked or accessed.

The scope of the project meets the Municipality of Chatham-Kent simple quote definition as per by-law #166-2020. This states that any procurement process in the range of \$5,000-\$30,000.00, requires a simple quote, and can be approved by the manager (Chief), without the direct involvement of the purchasing department. This project fell well within this range and no blanket contract exists for the deliverables. As per the by-law, CKPS contacted two suppliers for quotations. One supplier, APW Electronics was unable to accommodate the request and the second supplier was Integrated Audio Visual, who provided a detailed quote.

Integrated Audio Visual has conducted work over the last thirteen years for the Town of Amherstburg (2008), the Municipality of Leamington (2020), the Town of Essex (2013), Town of LaSalle (2020), the City of Windsor (2020), the Universities of Windsor/Western Ontario (2021) and as a sub-contractor for the Municipality of Chatham-Kent (Council Chambers-2015). Integrated Audio Visual has years of secure technological advancement for neighboring municipalities and our own municipality. In addition, they have met and surpassed the high security demands of the CKPS.

The quote (attached), \$20,523.16 with taxes, would include all features currently required to ensure a secure state of the art boardroom.

Project funding could come from the 2021 COVID-19 Provincial Relief Funding for Municipalities based on All Chiefs message broadcast 21-0034. Barring this source of funding, I would ask that they come from IT Reserves, as this is a one-time cost.

Prepared by:



Inspector Mike Domony

Recommended by:



Chief Gary Conn

Proposal To:

Chatham-Kent Police Service

24 3rd Street

Chatham. ON N7M 5K5

For:

Boardroom Audio / Visual System - Q-SYS

1.0

Attn: Quenting Sprik
February 10, 2021



INTEGRATED
A U D I O V I S U A L

sales@integratedav.ca
(519) 997-2444

SYSTEM OVERVIEW

The system is designed for maximum flexibility, ease of use and audio coverage.

Microphone and speakers:

The microphone will be mounted close to the ceiling at the centre of the room. It features the following technologies:

- Steerable Coverage™ technology with eight lobes to capture audio anywhere in the room
- Autofocus technology fine-tunes each lobe position in real time, even if meeting participants lean back or stand up.
- IntelliMix DSP includes automatic mixing, acoustic echo cancellation, noise reduction, and automatic gain control.
- Two in-ceiling speakers will provide sound from local sources and dialogue from the far side during a conference call.

Audio processor:

The processor features the latest in connectivity and processing technologies.

- 8 channels of analog audio inputs
- 8 channels of analog audio outputs
- 8 additional analog channels that can be utilized as audio inputs or outputs
- VOIP and phone line connectivity, without additional licenses or hardware required
- USB B audio for connectivity to a PC, perfect for soft codec applications such as Zoom, Skype and Microsoft Teams
- Audio echo cancellation
- Logic control, relay outputs, sense inputs and much more
- Touch panel with customized GUI. The ability to use manufacturer touch panels and Ipad for convenient portability

BOARDROOM

SCOPE

Provide and install:

- 75 inch LED display
- One Linear Array Microphone, designed for high-quality audio capture in premium AV conferencing environments. This will be installed below the ceiling at the centre of the room.
- Multi-channel audio processor with analog audio inputs & outputs, digital audio channels, audio echo cancellation, USB, VOIP and telephone line connectivity and much more.
- In-ceiling speakers and amplifier
- 120 degree wide angle USB camera
- Managed network switch with POE+
- Ipad - 8th generation, 10.2" screen
- Installation and programming (includes GUI design)

NOTE: We strongly encourage remote access during the commissioning stage, and intermittent access for the purposes of remote support when required.

AUDIO / VIDEO

QTY DESCRIPTION

- | QTY | DESCRIPTION |
|-----|---|
| 1 | NEC Display Solutions C751Q MultiSync C751Q - 75" Slim LED LCD Public Display Monitor, 3840 x 2160 (4K / UHD), 350 cd/m2, Anti Glare screen, HDMI In x3, DisplayPort x2 / out, OPS and RPi Slot Capable, Local Dimming, 3 Year Commercial Warranty (Suggested replacement model for E705, E705-PC3) |
| 1 | Apple MW752LLA 10.2 iPad 32GB Slv |
| 1 | Shure MXA710W-4FT Linear array microphone technology, for high-quality audio capture in premium AV conferencing environments. Features 8 independent channels with IntelliMix® DSP and Autofocus™ technology to provide all the processing needed for echo and noise-free conference audio. |
| 2 | QSC Cinema AC-C6T 6.5" Two-way ceiling speaker, 70/100V transformer with 8Ω bypass, 110° conical coverage, includes C-ring and rails for blind mount installation. Priced individually but must be purchased in pairs. |
| 1 | QSC CORE110F Q-SYS 128 Channel Core -No Card Slots - 16 x 16 |
| 1 | QSC SPA2-60 Half rack 1U, convection cooled power amplifier. Two channels of 60 watts per channel into 4Ω and 8Ω. Can also be bridged to supply 200 watts into 4Ω and 8Ω, and up to 250 watts into 70V or 100V. Class-D design. |
| 1 | D-Link DGS-1210-10P 10-PORT GIG SMART SWITCH POE |
| 1 | QSC SL-QUD-110-P UCI Deployment License for CORE110F |

QTY DESCRIPTION

- ViewSonic VB-CAM-001 1080p ultra-wide USB camera with built-in microphones compatible with Windows and Mac, compatible for IFP5550 / IFP6550 / IFP7550 / IFP6560 / IFP7560 / CDE7061T.
- 1
- 2 CEA Labour - Installation Remove projector, projection screen, up/down switch and unnecessary cabling.
- 1 Chief LSM1U Micro-Adjust Fixed Wall Mount Large

BOARDROOM TOTAL**\$13,900.00**



UPGRADE TO 86" NEC DISPLAY

SCOPE

This 86" (diagonal) NEC display, above all else provides high haze value, which reduces reflections and glare.

AUDIO / VIDEO

QTY DESCRIPTION

- 1 NEC Display Solutions C861Q MultiSync C861Q - 86" Slim LED LCD Public Display Monitor, 3840 x 2160

AUDIO / VIDEO TOTAL	\$6,950.00
SHIPPING AND TAXES	\$918.13

CREDITS FOR REPLACED ITEMS

- 1 NEC Display Solutions C751Q MultiSync C751Q - 75" Slim LED LCD Public Display Monitor, 3840 x 2160 (4K / UHD), 350 cd/m2, Anti Glare screen, HDMI In x3, DisplayPort x2 / out, OPS and RPi Slot Capable, Local Dimming, 3 Year Commercial Warranty (Suggested replacement model for E705, E705-PC3)

CREDITS	-\$4,312.50
SHIPPING AND TAXES	-\$560.63

SUMMARY

EQUIPMENT TOTAL	\$2,750.00
LABOUR	\$0.00
SHIPPING	\$0.00
HST	\$357.50
UPGRADE TO 86" NEC DISPLAY TOTAL	+\$3,107.50

UPGRADE TO 82" SAMSUNG DISPLAY

SCOPE

This 82" Samsung display offers exceptional features at an impressive price. The main difference besides size between this brand and NEC is the reflectivity of the screen (it's surface is not matt, therefore it tends to reflect room content and lighting).

AUDIO / VIDEO

QTY DESCRIPTION

- 1 Samsun LH82QETELGCXGO QE82T - Direct-Lit 4K Crystal UHD LED Display for Business

AUDIO / VIDEO TOTAL	\$3,550.00
SHIPPING AND TAXES	\$476.13

SUMMARY

EQUIPMENT TOTAL	-\$650.00
LABOUR	\$0.00
SHIPPING	\$0.00
HST	-\$84.50
UPGRADE TO 82" SAMSUNG DISPLAY TOTAL	-\$734.50



ACCEPTANCE

FINANCIAL

PAYMENT SCHEDULE

50% deposit upon acceptance, balance upon completion.

EQUIPMENT TOTAL \$13,900.00
SHIPPING TOTAL \$0.00

LABOUR TOTAL \$2,162.50

SUBTOTAL \$16,062.50
TOTAL HST \$2,088.13
PROJECT TOTAL \$18,150.63

OPTIONS Not included in the project total. Initial to the left to add the option to your project.

_____ UPGRADE TO 86" NEC DISPLAY +\$3,107.50
_____ UPGRADE TO 82" SAMSUNG DISPLAY -\$734.50

TERMS

I accept this proposal and hereby authorize Integrated Audio Visual to proceed with the installation of the included systems at the facilities of Chatham-Kent Police Service constructing at 24 3rd Street Chatham, ON N7M 5K5 as described in the totality of this document. I further authorize Integrated Audio Visual to be granted the facility access that will be required to complete this project in a workmanlike and timely manner and for payment to be made to Integrated Audio Visual. In keeping with the Terms of Payment listed above. It has been made clear to me that there exist no understandings regarding this project with any relevant party unless and until Chatham-Kent Police Service and Integrated Audio Visual agree to such additional or alternate understandings in writing. Project cost and pricing are dependent upon a continual flow of work without interruption or delays imposed by Chatham-Kent Police Service or their staff, construction, other building trades or any other party, and additional costs may be incurred by Chatham-Kent Police Service from Integrated Audio Visual. If such delays result in additional costs that are not covered by the pricing in this proposal. I agree that any additions to and/or deletions from the materials and labor to be provided by my acceptance of this proposal and any resulting change(s) in cost of this project shall only be by way of written change order(s) and shall be valid only after being signed by Chatham-Kent Police Service and Integrated Audio Visual. This proposal is valid only if accepted in writing by Chatham-Kent Police Service and deposit payment received no later than February 24, 2021.

ACCEPTANCE

CHATHAM-KENT POLICE SERVICE

SIGNED

DATE

PRINT NAME

TITLE

INTEGRATED AUDIO VISUAL

SIGNED

DATE

PRINT NAME

TITLE

NEC Ultra High Definition Large Format Displays

65", 75", 86" and 98" Commercial Displays Ideal for Digital Signage Applications

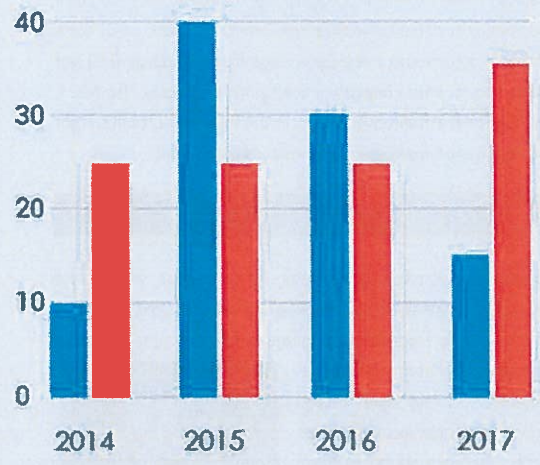

Brand new UHD displays in an aesthetically-focused design allows for seamless integration into any digital signage environment while maintaining the commercial ruggedness necessary for the retail, educational and corporate environments

Beyond Standard Signage

With industry leading experience in superior design and customer focus, the NEC large C series allow for clear, detailed imagery for unobtrusive digital messaging. New contemporary and slim mechanical design with focused aesthetics allows for the smooth and stylistic integration into any type of environment. Their full metal chassis coupled with real-time temperature sensors and integrated cooling fans maintain the professional quality necessary for commercial environments. With an anti-glare screen and ultra high definition panel, customers can enjoy the perfect image in any circumstance. These displays come equipped with a wide range of the latest connectivity interfaces including three separate HDMI 2.0 interfaces, two separate DisplayPort interfaces and a DisplayPort Out connection to complement the native Ultra High Definition at 60Hz panel. These displays also include expandability options such as the Open Pluggable Specification (OPS) and Raspberry Pi Compute Module slots for source integration directly into the display. The NEC C series boasts 350 - 400 cd/m² brightness that allows for efficient readability in higher ambient light situations and is ideal for 24/7 signage in airports, quick-serve restaurants, and retail.

Scalable Computing Power

Integrated computing options allow for cable free signage for any type of situation. The on-board multimedia player can be utilized for simple signage applications by allowing auto-play off of USB or SD card and content transfer via LAN. For more advanced signage systems, these displays contain an industry first ability to integrate a Raspberry Pi Compute module for near limitless potential and application. Finally, each display adheres to the Open Pluggable Specification that gives the ability to seamlessly integrate a full PC, HDBaseT receiver or other options directly into the unit.

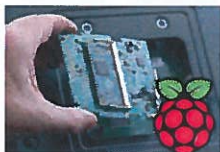

Advanced Heat Management

Monitoring and managing the temperature of each display is crucial to secure reliability and longevity. An industrial-strength, premium-grade panel with additional thermal protection, internal temperature sensors with self-diagnostics, and fan-based technology allows for 24/7 operation, and protects your display investment. Without thermal management, displays can be prone to damaging heat over time. This damaging heat will lower the picture quality and life expectancy of the product. Integrated cooling fans automatically turn on and stay on when high internal temperatures are detected. These will stay on until the heat is properly dissipated and the display remains under proper temperature thresholds.

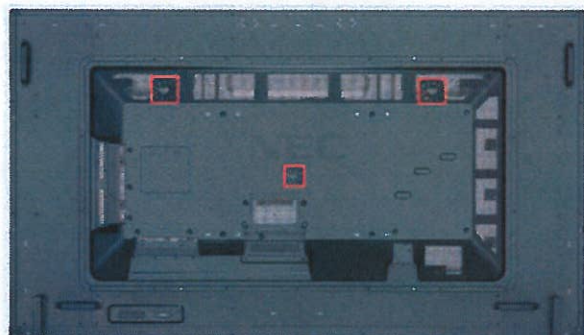

Location of Thermal Management Cooling Fans



Anti-Glare Panel

Each of the new large C series commercial displays come equipped with a high haze panel that scatters ambient lighting rather than reflecting it like most other displays. This allows for content to always be viewable and onlookers to have perfect screen readability in any situation.



With Anti-Glare



Without Anti-Glare

Blue ON LED and Ambient Light Sensor

New mechanical structure allows for sleeker LED and ambient light sensor design. Auto dimming of the LED backlights can be utilized through the ambient light sensor allowing for the brightness to change depending on the external lux in the room of installation.



SpectraView Engine

Enhanced imaging performance through advanced settings of all relevant parameters allow full control of brightness, color, gamma and uniformity via integrated color-critical chipset.



Key Guide

New Key Guide function allows for easier access to buttons when manually controlling the unit via the buttons on the back of the display by adding a graphic on the screen that directs the customer to the correct button layout in both landscape and portrait modes.

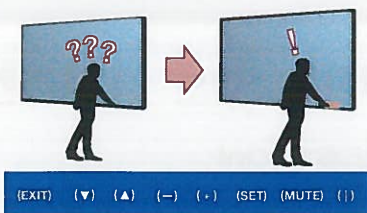

Aesthetically Focused Design

Brand new mechanical design focuses on smooth, sleek curves, thinner bezels, reduced depth and reduced overall weight while maintaining the quality and reliability for efficient 24/7 runtime capabilities.



NaViSet Administrator 2

This software is an all-in-one remote support solution that runs from a central location and provides monitoring, asset management and control functionality of the majority of NEC display devices and Windows computers. It is ideal for multi-device installations over larger infrastructures.



L-Shaped Connectivity

Connectivity is located on both the bottom and side of the display to allow for easy access regardless of orientation.

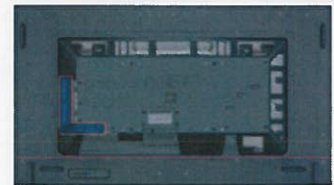

Cisco Compatible Partner:

Full compatibility with Cisco WebEx Kit products. The Cisco WebEx Kit is a professional video conferencing tool that has everything integrated into a single soundbar including microphone(s), camera(s), the speaker and the Video Conferencing Codec. This, combined with the large format NEC displays provide the ultimate conferencing solution.

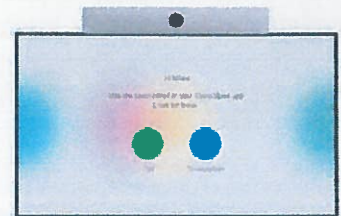

Removable Logo

When mounting from Landscape to Portrait orientation, there is now the ability to change the orientation of the logo or remove it all together

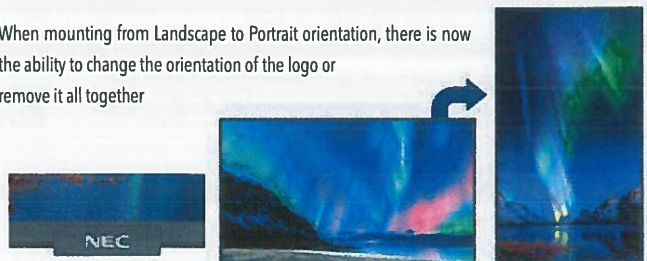

MODEL	C651Q	C751Q	C861Q	C981Q	
LCD MODULE	Panel Technology	D-LED, VA	E-LED, S-IPS		
	Viewable Image Size	65"	75"	86"	98"
	Native Resolution	3840 x 2160			3840 x 2160
	Brightness (Typical/Maximum)	320/400 cd/m ²			245 cd/m ² / 350 cd/m ²
	Contrast Ratio (Typical)	4000:1	1200:1 native, not including localized dimming		1300:1 native, not including localized dimming
	Viewing Angle	178° Vert., 178° Hor. (89U/89D/89L/89R) @ CR>10			
	Aspect Ratio	16:9			
	Displayable Colors	Over 1.07 Billion			
	Orientation	Landscape and Portrait			
	Panel Haze (%)	44	28		
CONNECTIVITY	Input Terminals	HDMI 2.0 x3 (with HDCP), DisplayPort 1.2 x2 (with HDCP)			
	Digital	HDMI 2.0 x3 (with HDCP), DisplayPort 1.2 x2 (with HDCP)			
	Analog	None			
	Audio	3.5mm Mini Jack, HDMI Audio x3, DisplayPort Audio x2			
	External Control	LAN (100Mbps), 3.5 Mini Jack IR Remote, RS232C			
	Data	microSD (Media Player), USB 2.0 (Media Player), USB 2.0 (Service), USB Type-B (Upstream), USB 2.0 x2 (Compute Module, USB CM1 is Powered 5V/2A)			
	Output Terminals	DisplayPort (Outputs DisplayPort1 and OPS (1CH DisplayPort Only))			
	Digital	DisplayPort (Outputs DisplayPort1 and OPS (1CH DisplayPort Only))			
	Analog	None			
	Audio	3.5mm Audio Mini Jack, External Speaker x2			
POWER CONSUMPTION	External Control	LAN (100Mb)			
	On (Typ/Max Brightness/Overall Max)	200W/255W/365W	195W/250W/375W	230W/300W/425W	240W/380W/525W
	Network Standby	2W			
	Normal Standby	0.5W			
	Current Rating	4.3A @ 100V, 1.8A @ 240W	4.4A @ 100V, 1.9A @ 240V	5.0A @ 100V, 2.1A @ 240V	6.1A @ 100V, 2.6A @ 240V
PHYSICAL SPECIFICATIONS	Speaker Rating	Integrated 10W x 2, Optional 15W x 2			
	Bezel Width (L/R, T/B)	12.9mm/12.9mm, 13.1mm/13.1mm	14.8mm/14.8mm, 14.8mm/14.8mm	15.3mm/15.3mm, 15.3mm/15.3mm	15.9mm/15.9mm, 15.9mm/15.9mm
	Net Dimensions (Without stand; W x H x D)	57.34 x 32.7 x 3.1in. 1457.0 x 831.6 x 79.4mm	66.2 x 37.8 x 2.8in. 1681.2 x 959.6 x 71.1mm	75.9 x 43.3 x 2.9in. 1928.2 x 1099.2 x 74.3mm	86.4 x 49.2 x 3.7in. 2193.8 x 1248.8 x 93.0mm
	Net Weight (Without Stand)	89.9lbs / 40.8kg	115.7lbs / 52.6kg	127.2 lbs. / 57.8kg	198.6 lbs / 90.0kg
	VESA Hole Configuration	8x M8 x 16mm (600 x 400, 400 x 400)			
SENSORS	Ambient Light Sensor	Integrated and programmable			
	Human Sensor	Optional through KT-RC2 Accessory			
	Temperature Sensor	Integrated and programmable; linked to cooling fans			
	NFC Sensor	Integrated; works in conjunction with free NEC Intelligent Wireless Data Application			
ENVIRONMENTAL CONDITIONS	Operating Temperature	0 to 40C			
	Operating Humidity	20-80%			
	Operating Altitude	3000m (9843ft)			
LIMITED WARRANTY	3 years Advanced Replacement				
ADDITIONAL FEATURES	HDR Gamma Support (HLG nand PQ), Localized Dimming, Ambient Light Sensor, AMX Support, Auto ID/Auto TileMatrix, Automated Email Alert Function, CEC Support through HDMI, Crestron Roomview Support, DICOM Simulation, Display Browser Control, Display Wall Calibrator Compatible, High Haze Panel, Image Flip, Intelligent Wireless Data (NFC), Key Guide, Media Player through Browser Control/SD Card/USB, Multi Picture Mode, Naviset Administrator 2 Compatible, OSD Rotation for Portrait Orientation, OPS Compatible, PJ Link Support, Point Zoom Function, Power USB Port (5V/2A), Programmable LUT x3, Raspberry Pi Compute Module Compatible, Removable Logo Ornament, Real Time Clock, SpectraView Engine Support, SNMP Support, 24-Hour Scheduler Function, Cisco Compatible				
SHIPS WITH	3m AC Power Cord, 1.8m HDMI cable, 1.8m DisplayPort Cable, IR Remote Control, Batteries, CD-ROM (User Manual)				
OPTIONAL ACCESSORIES	Table Top Stand (ST-801), Optional Speakers (SP-TF1), All OPS Option Cards, Raspberry Pi Compute Module 1 and 3 with optional NEC Interface Board, Large Wall Mount (WMK-6598), Regular Wall Mount (WMK-3257 for C651Q, C751Q, and C861Q only) Slim Wall Mount (WMK-32555 for C651Q), Human Sensor (KT-RC2)				

Dimensions

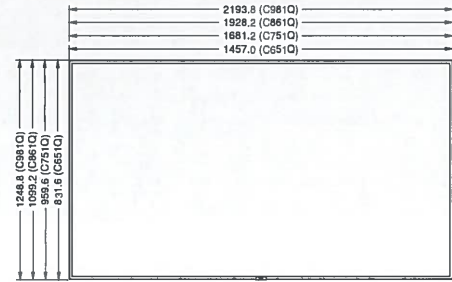

Options

OPS PC's

OPS-PCAEQ-PS2

OPS-APIS-PS

OPS-TCIS-PS



SDI

HD-SDI SB-01HC

3G-SDI SB-04HC



HDBaseT SB-07BC



Compute Module

Compute Module Interface Board DS1-IF10CE

NEC Raspberry Pi Compute Module RP3CM166B



Tabletop Stand

ST-801



Speaker

SP-TF1

Input Panels

- HDMI IN2
- HDMI IN3
- DisplayPort IN2
- DisplayPort IN1
- DisplayPort OUT
- Audio IN
- External Speaker Terminal
- Internal/External Speaker Switch
- Audio OUT
- USB1
- USB2
- USB CM1 (2A)
- USB CM2
- LAN1
- LAN2
- USB MP
- microSD
- REMOTE IN
- RS-232C
- HDMI IN1

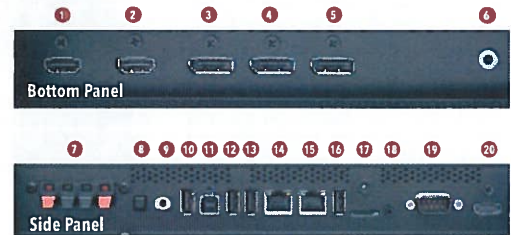

MultiSync, Naviset and TileMatrix are trademarks or registered trademarks of NEC Display Solutions, Ltd. in Japan, the United States and other countries. The terms HDMI and HDMI High-Definition Multimedia Interface, and the HDMI Logo are trademarks or registered trademarks of HDMI Licensing LLC in the United States and other countries. DisplayPort and DisplayPort Compliance Logo are trademarks owned by the Video Electronics Standards Association in the United States and other countries. HDBaseT™ and the HDBaseT Alliance logo are trademarks of the HDBaseT Alliance. CRESTRON and CRESTRON ROOMVIEW are trademarks or registered trademarks of Crestron Electronics, Inc. AMX is a trademark or registered trademark of AMX in the United States and other countries. VESA is a trademark of a nonprofit organization, Video Electronics Standard Association. All other trademarks are the property of their respective owners. The images in this brochure are samples. All specifications are subject to change without notice.

©2018 NEC Display Solutions of America, Inc. and the NEC logo are registered trademarks of NEC.



SHURE

MICROFLEX® ADVANCE™

MXA710 LINEAR ARRAY MICROPHONE

OVERVIEW

The Shure Microflex® Advance™ MXA710 Linear Array Microphone represents the next evolution in Shure array microphone technology, designed for high-quality audio capture in premium AV conferencing environments. The linear form factor of the MXA710 allows for placement virtually anywhere in a meeting space, including on a wall, around a display, on a ceiling, or in a conference room table.

FEATURES

- Steerable Coverage™ technology to capture audio anywhere in the room (up to 4 lobes with a 2-foot array, 8 lobes with a 4-foot array)
- Autofocus technology fine-tunes each lobe position in real time, even if meeting participants lean back or stand up.
- Default room coverage template enables quick and easy lobe optimization for wall, ceiling, or table installations.
- IntelliMix DSP includes automatic mixing, acoustic echo cancellation, noise reduction, and automatic gain control.
- Shure Designer System Configuration software for easy setup and configuration
- SystemOn Audio Asset Management software for remote management and troubleshooting
- PoE powered
- LED status bars with configurable colors and brightness
- Dante & AES67 audio networking protocols
- Shure network audio encryption compatible
- Multiple mounting accessories for wall, ceiling, or table installation

SPECIFICATIONS (subject to change)

GENERAL

All specifications measured from narrow lobe width. Values for all widths are within ± 3 dB of these specifications unless otherwise noted.

Lobe Width (adjustable)	Narrow 30 degrees, Medium 40 degrees, Wide 70 degrees
Connector Type	RJ45
Power Requirements	Power over Ethernet (PoE), Class 0
Power Consumption	10 W maximum
Control Software	Shure Designer
Plenum Rating	UL2043 (Suitable for Air Handling Spaces)
Dust Protection	IEC 60529 IP5X Dust Protected
WEIGHT	
MXA710-2FT	2 lbs (0.91 kg)
MXA710-4FT	3.7 lbs (1.67 kg)

PRODUCT DIMENSIONS

MXA710-2FT	0.87 x 2.36 x 25.04 in. (22.09 x 60 x 636 mm) H x W x L
MXA710-4FT	0.87 x 2.36 x 49.12 in. (22.09 x 60 x 1247.76 mm) H x W x L
Operating Temperature Range	-6.7°C (20°F) to 40°C (104°F)
Storage Temperature Range	-29°C (-20°F) to 74°C (165°F)

AUDIO

Frequency Response	100 Hz to 20 kHz
AES67 or Dante Digital Output	
Channel Count MXA710-2FT	6 total channels (4 independent transmit channels, 1 Automix output, 1 AEC reference in channel)
Channel Count MXA710-4FT	10 total channels (8 independent transmit channels, 1 Automix output, 1 AEC reference in channel)
Sampling Rate	48 kHz
Bit Depth	24
Sensitivity at 1 kHz	
MXA710-2FT	-7.4 dBFS/Pa
MXA710-4FT	-7.9 dBFS/Pa

www.shure.com



MXA710
Microflex Advance Linear Array
Microphone



MXA710
Flush Mount



MXA710
with Full Box Contents



A710-DS Desk Stand



A710-MSA Mic Stand Adapter

© 2020 Shure Incorporated



Maximum SPL Relative to 0 dBFS overload

MXA710-2FT	101.4 dB SPL
MXA710-4FT	101.9 dB SPL
Signal-To-Noise Ratio (Ref. 94 dB SPL at 1 kHz)	71.2 dB A-weighted

Latency (Does not include Dante latency)

Direct Outputs	8.7 ms
Automix output (Includes IntelliMix processing)	19.3 ms

Self Noise

MXA710-2FT	22.9 dB SPL-A
MXA710-4FT	22.8 dB SPL-A

Dynamic Range

MXA710-2FT	78.5 dB
MXA710-4FT	79.1 dB

Built-in Digital Signal Processing

Automatic mixing, Acoustic Echo Cancellation (AEC), Noise Reduction, Automatic Gain Control, Compressor, Delay, Equalizer (4-band Parametric), Mute, Gain (140 dB range)

Networking

Cable Requirements	Cat 5e or higher (shielded cable recommended)
--------------------	---

Data subject to change without notice in interest of product improvements.

MXA710 Frequency Response

Frequency response measured directly on axis from a distance of 6 feet (1.83 m)

MXA710-2FT

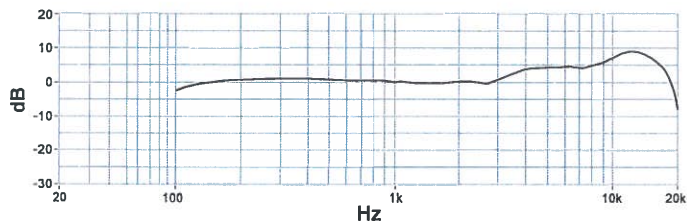

MXA710-4FT

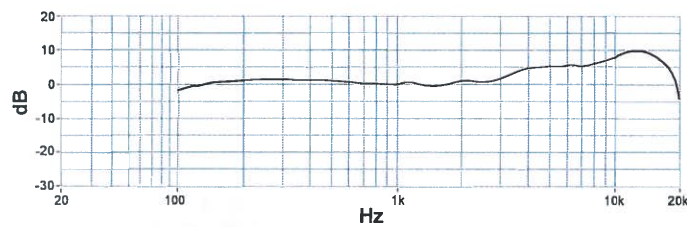

OPTIONAL ACCESSORIES

- A710-FM-2FT Flush Mount Kit - 2 Foot
- A710-FM-4FT Flush Mount Kit - 4 Foot
- A710B-DS Desk Stand, Black
- A710AL-DS Desk Stand, Aluminum
- A710-MSA Mic Stand Adapter
- A710-TB Tile Bridge



AcousticCoverage™ Series

AC-C6T

Two-way, ceiling mount loudspeaker

Features

- High quality transducers provide exceptional clarity through the critical voice range.
- Improved musicality often not seen in typical BGM class products.
- Ported baffle for increased low frequency extension down to 65 Hz.
- Low saturation 70/100V transformers with 8 ohm bypass.
- 4-pole Euroblock connector eases system wiring.
- Advanced voicing via QSC Intrinsic Correction™, applied using the Q-SYS™ Platform or CXD Series amplifiers platforms.
- White (RAL 9010) with UV inhibitors to match complimenting QSC product families.
- Complete EASE, CF2, CAD, & BIM information available online



Wide Area Paging · Background Music · Distance Conferencing Reinforcement · Healthcare Facilities · Concourses · Transportation Terminals · Ancillary Support in Larger Systems

The QSC AcousticCoverage™ Series AC-C6T is a ceiling-mounted 6" two-way loudspeaker with 70/100V transformer, suitable for a wide variety of audio/video conferencing reinforcement, voice paging and background music applications.

AcousticCoverage™ Series is designed to offer integrators a cost-effective solution for applications where voice reinforced coverage is of primary concern, while providing improved musicality often not seen in typical BGM class products.

The high quality 6-inch polypropylene cone transducer with butyl rubber surround and the sensitivity matched coaxially mounted .86-inch silk dome tweeter offers pristine clarity through the critical vocal range for increased speech intelligibility. With 110 degrees of conical coverage, the AC-C6T reduces the number of loudspeakers required for even coverage in low ceiling applications.

The easy-to-install blind mount assembly features a ported baffle which optimally tunes the galvanized steel backcan for added musicality, creating low frequency extension down to 65 Hz. To maintain this frequency response, the AC-C6T utilizes a 30-watt low-saturation and low-loss 70/100V transformer with varying selectable taps, including an 8Ω bypass. The rotary tap selector switch is accessible under the painted steel grille.

To further enhance performance and speed of install with optimum result, advanced voicing via QSC Intrinsic Correction™ techniques are obtainable using the Q-SYS™ Platform networked audio processing platforms, including CXD Series amplifiers for a complete QSC systems solution.

Installers will appreciate the 4-pole Euroblock connector for loop-thru wiring, located under a quick access swivel plate. Eliminating the termination hassles of star topology wiring designs, the generous Euroblock of the AC-C6T can accept four 18AWG pairs.

A safety tether tab is affixed to the adjustable conduit clasp plate for seismic-sensitive installations. C-ring and tile rails are included with each pair packed assembly, complete with joining screws and cut-out template.

The AC-C6T baffle and grille are QSC standard white (RAL 9010) to match complimenting QSC product families and includes UV inhibitors to prevent discoloration over time. The AC-C6T may also be painted to match any décor.

For your system integration needs, complete EASE, CF2, CAD, and BIM files are available for download at QSC.com.

AC-C6T Details

Beamwidth:

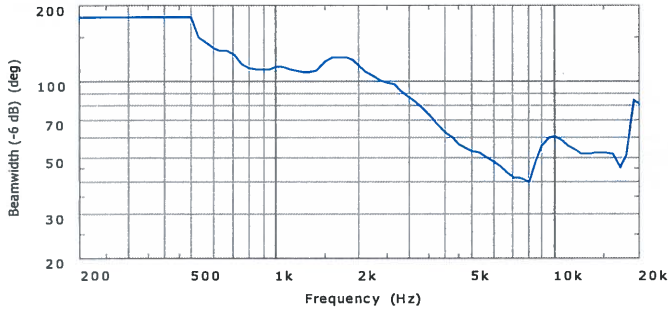

Impedance / Frequency Response:

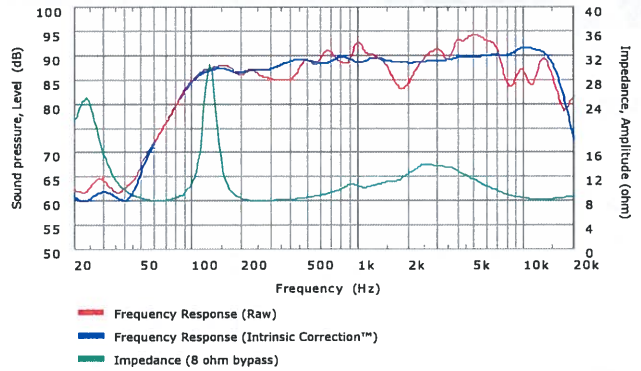

Dimensions

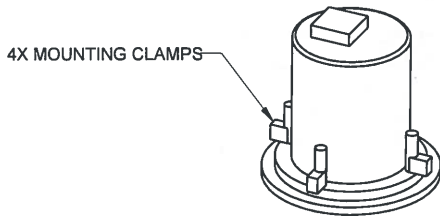
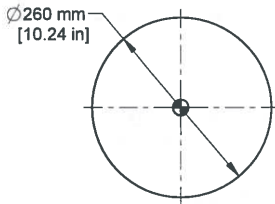
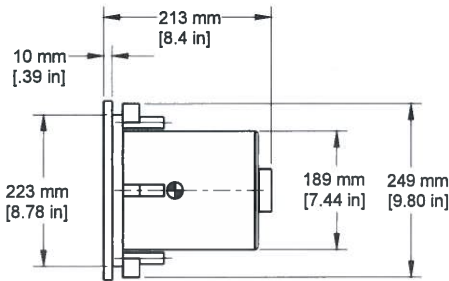

Specifications:

System Details	AC-C6T
Effective frequency range ¹	65 Hz – 20 kHz
Rated noise power / voltage ²	30 watts / 15.5 volts (rms)
Broad-band sensitivity ³	89 dB SPL
Coverage angle (-6 dB)	110° (500 Hz - 5 kHz)
Maximum continuous SPL ⁴	104 dB
Maximum peak SPL ⁴	110 dB
Rated bypass impedance	8 ohms
Transformer taps	70 V: 30, 15, 7.5, 3.7, 1.9 watts 100 V: 30, 15, 7.5, 3.8 watts 8 ohm bypass
HF transducer	22 mm [.86 in] silk dome tweeter, coaxially mounted
LF transducer	152 mm [6 in] Polypropylene cone with butyl rubber surround
Input connector type	Euroblock connector with parallel output terminals
Baffle material	Painted ABS polymer
Grille material	Painted steel
Back can material	Galvanized steel
Testing	Listed UL1480, UL2043 safe for use in air handling space
Net weight	3.5 kg [7.6 lb]
Product dimensions	Ø260 x 213 mm [Ø10.24 x 8.4 in]
Cut-out Dimensions	Ø229 mm [Ø9 in]
Ceiling Capture Thickness	6.35 - 38.1 mm [0.25 - 1.5 in]
Shipping weight	9.5 kg [21 lb] (pair packed)
Shipping dimensions	622 x 318 x 324 mm [24.5 x 12.5 x 12.8 in]
Included accessories	Rails & C-ring for ceiling tile installation

¹ Half-space, -10 dB from on-axis sensitivity ² IEC60268-1 noise signal for 2 Hrs
³ On-Axis, half-space sensitivity, 2.83V, 1 m ⁴ Calculated from rated noise voltage and sensitivity

As part of QSC's ongoing commitment to product development, specifications are subject to change without notice.



1675 MacArthur Boulevard • Costa Mesa, CA 92626 • Ph: 800/854-4079 or 714/957-7100 • Fax: 714/754-6174

© 2016 QSC, LLC all rights reserved. QSC and the QSC logo are registered trademarks of QSC, LLC in the U.S. Patent and Trademark office and other countries. AcousticCoverage, Intrinsic Correction and Q-SYS are trademarks of QSC. All other trademarks are the property of their respective owners. Patents may apply or be pending.

AC-C6T Spec Sheet 12/02/2016





Q-SYS Core 110f

Unified Core

Features

- 128x128 Network Audio Channels
- 16x16 USB Audio Channels
- 24 Channels of Total Analog Audio
- 8 Configurable Flex Channels
- 16x16 GPIO Logic Ports
- 16 Channels of Routable AEC
- Multiple Instance VoIP Lines
- Single POTS Telephone line
- 3 Year Warranty



The Q-SYS™ Core 110f provides a solution for small, single room allowing the Q-SYS platform to accommodate every-day, simple projects up to the largest Enterprise scale deployments. QSC's software based DSP Platform Q-SYS, gives the systems integrator and end-user a unified software design tool and feature set suitable for projects of any scale. The continuity of the Q-SYS software based DSP platform is unique within the competitor space and allows the Q-SYS Core 110f to leverage all the features that are available across the entire Q-SYS Platform to be used in the following applications: Acoustic Echo Canceling (AEC) and sound reinforcement in small to large meeting or multipurpose rooms, sound reinforcement in performance venues such as house of worship and theater, background music systems, wide area paging in airports, convention centers and hospitals.

The Q-SYS Core 110f is a multipurpose software based digital audio signal processor with a total of 8 balanced analog line level audio inputs and 8 balanced analog line level audio outputs. In addition to the fixed 8x8 analog audio I/O, the Core 110f features a software definable bank

of 8 balanced analog audio Input/Output Flex Channels, a unique QSC innovation, where each channel can be independently configured during design or run time as either a microphone/line level input or a line level output. As such, the Core 110f offers class leading 24 analog I/O density plus additional specialized I/O such as VoIP, POTS, Internal Media Playback/Recording HDD and USB.

The Q-SYS Core 110f supports a class leading USB audio device port connection that enables the processor to appear in a Microsoft Windows or Mac OS host operating system simultaneously as both a USB Audio and Communications device. The USB Device port (B type) implementation supports up to 16x16 digital audio channels in a flexible, design time configuration environment that can advertise as multiple virtual USB device instances to the host operating system concurrently over a single physical USB connection. In addition to the USB Device port, the Core 110f provides 6 USB Host ports (A type) which enable the Core to host external USB devices and future Q-SYS peripheral products.

Benefits

- **Class leading I/O:** Q-SYS Core 110f has 24 analog I/O + USB, POTS and VoIP simultaneously in a single rack space and one SKU, offering the best cost to I/O ratio in a single chassis product available on the market from any manufacturer.
- **Flex Channels:** Nearly all the flexibility of a card based DSP solution without the cost and inconvenience of multiple SKU's and custom parts ordering.
- **Unified software platform:** Single training investment in one software design tool rather than needing to learn several platforms to scale from small to large systems or support different applications.
- **Industry leading hardware design:** Future proof investment in standards based software and computer technology running on Intel processors.
- **Industry first, software based DSP:** Q-SYS suite of conferencing technology applications built and owned by QSC from the ground up allowing for continued refinement.
 - o Software based routable AEC; no additional hardware needed
 - o SIP Softphones offering multiple instances per Q-SYS Core; no additional hardware needed
 - o Gain sharing and gating automixers
- **True IT Software Integration:** The Core 110f provides more than just networked audio integration and is not just another hardware DSP. Q-SYS is primarily a software platform that offers greater software integration functionality such as native support for LDAP contact server integration, SNMP monitoring, SIP Softphones, and software based routable AEC implementation; it truly is a next generation AV/IT product that is free of the fixed hardware limitations seen in competing products.

Key Features

- 128x128 networked audio channels (Q-LAN / AES67), reduced to 64x64 when using Video Bridging capability on built-in USB-B port.
- Up to 24 configurable analog audio I/O
- 8 mic/line level analog audio inputs
- 8 line level analog audio outputs
- 8 Flex Channel mic/line level analog audio inputs or outputs
- Up to 16 assignable and routeable AEC processor instances
- Dual Gigabit Ethernet ports with assignable application resources offering any combination of VoIP, Q-LAN Control, Q-LAN audio or network redundancy
- Up to 16x16 channels of digital audio in and out via software definable USB instances advertised to the host operating system
- 16 General Purpose Inputs (GPI) x 16 General Purpose Outputs (GPO)
- Internal Universal Power Supply plus 12 Volt DC External Power Supply input for redundancy or non-mains power supply sources
- Single software platform for system configuration, control and monitoring via Q-SYS Designer software over Ethernet with support for static or Auto/DHCP TCP/IP addressing
- POTS telephone interface via a standard RJ-11 connector
- Supports up to 4 VoIP Softphone instances in addition to the onboard POTS telephone interface
- Fully compatible with all existing and future Q-SYS accessories such as IO Frames, Paging Stations, and Touch Screen Control Surfaces running Q-SYS user control interfaces
- CE marked, UL listed, and RoHS compliant
- Covered by QSC Systems 3-year warranty



Q-SYS Core 110f

Inputs

Q-SYS Core 110f

Input Frequency Response

20Hz to 20kHz @ +21dBu +0.05% / -0.5%

Input THD+N @ 1KHz

@ +21 dBu Sensitivity & +21 dBu input < 0.1%
@ +21 dBu Sensitivity & +10 dBu input < 0.0015%
@ +10 dBu Sensitivity & +8 dBu input < 0.0007%
@ -10 dBu Sensitivity & -10.5 dBu input < 0.0006%
@ -39 dBu Sensitivity & -39.5 dBu input < 0.007%

EIN (no weighting, 20Hz to 20kHz) < -121dB

Input to Input Crosstalk @1kHz > 110dB typical, 90dB Max

Input Dynamic Range

@ +21 dBu Sensitivity > 109.5dB
@ +10 dBu Sensitivity > 106.4dB
@ -10 dBu Sensitivity > 104.6dB
@ -39 dBu Sensitivity > 104.6dB

Input Common Mode Noise Rejection

@ +21 dBu Sensitivity 50.7dB
@ +10 dBu Sensitivity 56.5dB
@ -10 dBu Sensitivity 73.2dB
@ -39 dBu Sensitivity 63.2dB

Input Impedance (balanced) 5K ohms nominal

Input Sensitivity Range (1dB Steps) -39 dBu min to +21 dBu max

Unbalanced Input Signal Level + 8 dBu max

Phantom Power +48V DC, 10mA per input max

Sampling Rate 48kHz

A/D – D/A Converters 24-bit

Outputs

Output Frequency Response

20Hz to 20kHz @ all settings +0.2 / -0.5 dB

Output THD 0.003%, +10 dBu max output level

Output Crosstalk @1kHz > 100dB typical, 90dB max

Output Dynamic Range > 108dB

Output Impedance (balanced) 220 ohms

Output Level Range: (1dB Steps) -39 dBu min to +21 dBu max

USB Inputs & Outputs

USB B

Bit Depth 16-bit

Number of Channels up to 16x16

Sample Rate 48kHz

Power Consumption 60 watts, typical. 120 watts max

BTU/Heat load: 205 BTU/Hour

Compliance FCC Part 15B (USA), FCC part 68 / TIA-968-B (USA), JATE (Japan), AS/ACIF S002 (Australia), PTC200 (New Zealand), ES203 021 (Europe), ANATEL Resolution 473 (Brazil), NOM-151-SCTI (Mexico), PSTN01 (Taiwan), Industry Canada CS-03 (Canada), CE marked (Europe), UL and C-UL listed (USA & Canada), RCM (Australia), EAC (Eurasian Customs Union) & RoHS Directive (Europe)

Overall Dimensions/Weight Device Height: 1.75 inches (44 mm) Shipping Height: 6.0 inches (152 mm)

Device Width: 19.0 inches (483 mm) Shipping Width: 23 inches (584 mm)

Device Depth: 11.12 inches (282.5 mm) Shipping Depth: 14 inches (356 mm)

Device Weight: 11 lbs. (5.0 kg) Shipping Weight: 12.4 lbs. (5.6 kg)

Specifications subject to change without notice

A&E SPECIFICATIONS

The system processor shall provide up to 128 x 128 networked audio channels individually configurable as either Q-LAN or AES67 formatted networked audio, channel count will reduce to 64 x 64 when using video bridging capability on the built-in USB-B device port. The system processor shall support 24 total analog I/O capacity and shall be presented in the following groupings; 8 Mic/Line inputs, 8 Line outputs and 8 Flex Channel I/O which shall be software definable analog inputs or outputs in single channel increments in any combination ratio.

The system processor shall have the following front panel controls and indicators: blue monochrome OLED display with page forward capacitive touch button, Unit ID capacitive touch button, Power On blue LED, Two USB A Type ports. The system processor shall provide a monochrome 304x96 blue OLED graphics display displaying the device name, design name and system status, LAN A and B settings, and the firmware version. Device Status shall be displayed on the OLED display including I/O status, muting, level present indication, and system status.

On the rear panel, the system processor shall have one 3-pin RS232 Euro Block Connector, HDMI Video Out, 16 GPI general purpose control inputs on 20-pin Euro Block Connector, 16 GPO general purpose control outputs on 20-pin Euro Block Connector. Q-SYS Network: LAN A RJ45 1000 MBps only, LAN B: RJ45 1000 MBps only. The dimensions of the System processor shall be 1.75" x 19" x 11.12" (44 mm x 483 mm x 356 mm).

The system processor shall store a single design which can be comprised of components, wiring, links, text, and graphics on a single or multiple schematic pages. Designs shall include any of the following DSP function blocks, test and measurement components, control components, and layout components: Acoustic Echo Cancellers, SIP Softphone instances, USB Audio host and device blocks, Audio Players, Audio Streaming components, Crossfaders, Crossovers, Delay components, Auto Gain control elements, Compressors, Gates, Duckers, Expanders, Ambient Noise Compensators, Limiters, Gain blocks, Graphic Equalizers, Parametric Equalizers, FIR Filters, All-Pass Filters, Band-Pass Filters, Band-Stop Filters, High-Pass Filters, Low-Pass Filters, FIR High-Pass filters, FIR Low-Pass Filters, Dual-Shelf Equalizers, Notch Filters, Meters, Matrix Mixers, Gain-Sharing Automatic Mixers, Gated Automatic Mixers, Signal Routers, Public Address Routers, Room Combiners, Signal Presence Meters, Tone Generators, Tone and Noise Generators, Dual Trace FFT Measurement Modules, Real Time Analyzers, Signal Injectors, and Signal Probes.

The system processor shall support custom user control interfaces on either proprietary touch screen controllers, or network computers utilizing a control application, or iOS devices on Wi-Fi. Custom control interfaces shall be capable of having multiple user-selectable pages with different controls on each.

The system processor and control engine shall be the QSC Q-SYS Core 110f Flex Channel Processor.





SPA Series

SPA2-60 | SPA4-60
SPA2-200 | SPA4-100

Low-Z / High-Z Professional Amplifiers

Features

- **Up to 200 watts per channel into 4 and 8 ohms** - the outputs of the SPA2 and SPA4-60 models are designed to provide up to 60 watts per channel while the SPA4-100 will provide up to 100 watts and the SPA42-200 will provide up to 200 watts per channel into Low-Z loads
- **ENERGY STAR qualified amplifier** - The ENERGY STAR qualified SPA Series employ an efficient class-D design to conserve energy and reduce operational cost
- **Bridgeable outputs for higher power** - Bridging the outputs of the SPA -60 amplifiers provide up to 250 watts, while the SPA2-200 and the SPA4-100 will deliver up to 350 watts into 70V or 100V when bridged
- **Auto-Ramp provides quiet startup and power-down** - The ENERGY STAR auto-ramp circuitry ensures quiet and fast power up from standby and seamless power-down following 25 minutes of inactivity, dramatically reducing power consumption
- **Rack-mountable 1U, half rack width enclosure** - The SPA Series can be mounted in 1 RU, 1/2 rack space, and their clever joining brackets enable easy under-table and wall-mounting

SPA2-60 | SPA4-60
SPA2-200 | SPA4-100



The SPA Series amplifiers from QSC are four half rack 1U, convection cooled power amplifiers delivering two or four channels of up to 200 watts per channel into 4 Ω and 8 Ω . These amps can also be bridged to supply up to 400 watts into 4 Ω and 8 Ω , and up to 350 watts into 70V or 100V loads making them extremely flexible for Low-Z or High-Z applications. Utilizing an advanced Class-D amplifier design and Universal Power Supply the SPA Series are efficient, allowing them to be convection cooled and are ENERGY STAR qualified with quiet auto-ramp standby functionality. The SPA Series are housed in an unobtrusive black painted 1/2 RU chassis with unique mounting hardware enabling rack, table and wall mounting capabilities.

SPA2-60 & SPA4-60

The SPA2-60 two channel amplifier and SPA4-60 four channel amplifier both deliver 60 watts rms per channel into 4 or 8 ohms; the channels can also be bridged providing up to 200 watts rms into 4 or 8 ohms per channel pair. The bridged channels can be switched into 70V or 100V direct drive mode providing up to 250 watts rms into a 70V or 100V output. An 80Hz highpass filter is engaged when in 70V or 100V mode ensuring that distributed loudspeaker transformers are not overdriven and saturated by too much low frequency content.

SPA2-200

For higher power the SPA2-200 two channel amplifier delivers up to 200 watts rms per channel into 4 or 8 ohms; the two channels can also be bridged providing up to 400 watts rms into 4 or 8 ohms. When the channels are bridged they can be switched into 70V or 100V direct drive mode providing up to 350 watts rms into a mono 70V or 100V output. Like the other SPA models, an 80Hz highpass filter is engaged when in 70V or 100V mode.

SPA4-100

The SPA4-100 four channel amplifier delivers 100 watts rms per channel into 4 or 8 ohms; the four channels can also be bridged in pairs, each pair providing up to 200 watts rms into 4 or 8 ohms. The SPA4-100 bridged pair channels can be switched into 70V or 100V direct drive mode providing up to 350 watts rms into a 70V or 100V output; when in 70V or 100V mode the 80Hz highpass filter is automatically engaged.

Efficient Amplifier with Auto-Ramp

The SPA Series amplifiers utilize a highly efficient class-D design that conserves energy to reduce operational costs and requires no active cooling. They are ENERGY STAR qualified with auto-ramp circuitry that seamlessly transitions to/from Standby with no audible pops.

Amplifier Protection

Both amplifiers in the SPA Series feature rms and thermal limiting, as well as protection against over current, short circuit, and under/over voltage.

Protection, Control and Mounting

The SPA Series provide rms and thermal limiting as well as over-current and short-circuit protection so you can employ them with confidence. They also come with multiple mounting options. Every SPA Series comes with a complete mounting kit allowing it to be rack mounted by itself or with a second unit in a 1RU space. Included connecting brackets provide additional strength when rack mounting two amps together, but also make for simple under-table or wall mounting (like behind a TV). The SPA Series can also be mounted in plenum spaces when used with the Plenum Kit accessory.

SPA Series

	SPA2-60	SPA4-60	SPA2-200	SPA4-100
Channels	2	4	2	4
Stereo Mode (all channels driven)				
8Ω	60 W	60 W	200 W	100 W
4Ω	60 W	60 W	200 W	100 W
Bridged Outputs (per bridged output pair)				
8Ω & 4Ω	200 W	200 W	400 W	200W
70V	250 W	250 W	350 W	350 W*
100V	250 W	250 W	350 W	350 W*
Frequency Response (4Ω and 8Ω)	20 Hz - 20 KHz +/- 0.1 dB			
Signal to Noise (20 Hz - 20 KHz)	>100 dB			
Input Sensitivity	1.23V (+4 dBu)			
Gain at 8Ω	25.0 dB			
Output Circuitry	Class D			
Input Impedance	>10k, balanced or unbalanced			
Maximum Input Level	12.3V (+24 dBu)			
Cooling	Convection			
Input Connectors	3.5 mm Euro, 5 position (green)		3.5 mm Euro, 10 position (green)	
Remote Connectors	3.5 mm Euro, 5 position (black)		3.5 mm Euro, 10 position (black)	
Output Connectors	5 mm Euro, 4 position (green)			
Front Panel Indicators	Power, per channel Signal, per channel Protect/Limit			
Rear Panel Indicators	Bi-Color LED Signal/Protect/Limit per channel			
Controls	4Ω/8Ω/70V Bridged Highpass On/100V Bridged Highpass (per channel pair)			
General Purpose Inputs	Remote Volume, Remote Standby, on 3.5 mm connectors (10k potentiometer is not included)			
Highpass Filter	80Hz in Bridged 70V & 100V			
Dimensions	1.7" x 8.7" x 9.5" (43 mm x 220 mm x 241 mm)			
Net Weight	3.5 lb (1.1 kg)		4.0 lb (1.4 kg)	
Shipping Weight	6 lb (2.3 kg)		6.5 lb (2.5 kg)	
Power Requirements	Universal Power Supply 100 - 240 VAC, 50 - 60 Hz with active power factor correction			
Agency Approvals	UL, CE, Energy Star, RoHS/WEEE compliant, FCC Class B (Conducted and Radiated emissions), UL 2043 with Plenum Kit accessory			
Carton Contents	IEC Cable, Quick Start Guide, Connector Pack, Rack Mount Ears, Mounting Brackets			

Specifications subject to change without notice.
*Peak Power – dependent on other channel loads.



1675 MacArthur Boulevard • Costa Mesa, CA 92626 • Ph: +1.800.854.4079 or +1.714.957.7100 • Fax: +1.714.754.6174
©2016 QSC, LLC all rights reserved. QSC and the QSC logo are registered trademarks of QSC, LLC in the U.S. Patent and Trademark office and other countries. All other trademarks are the property of their respective owners. Patents may apply or be pending.



Key Features

- 1080p resolution with a 120° wide angle field of view
- Built-in microphone with noise reduction
- WDR and backlight compensation for bright and dark environments
- On-top mounting kit with forward tilt
- Plug-n-play with USB 2.0, working on Windows/Mac/Android/Chrome OS



Product Description

When mounted on a ViewBoard, the ViewSonic VB-CAM-001 web camera brings all remote participants together with remarkable audio-visual performance as if they were in the same room. The wide field of horizontal and vertical view, clear image display in bright and dark environments, and background noise reduction, make the VB-CAM-001 an ideal web camera for any modern classroom or meeting room.

Visit Us - www.viewsonic.com

OPERATING SYSTEM

Windows® 7, Windows 8.1, Windows 10 or above, macOS™ 10.10 or above, Chrome OS, Android 5.0 or above

SYSTEM REQUIREMENT

CPU Recommended: Intel® Core 2 Duo processor or above

RAM Recommended: 2G RAM or above

CAMERA

Sensor: CMOS, 2.07M Pixels

Field of View (FOV): 120°

White Balance: Auto, Manual, VAR

Digital Noise Reduction: 2D, 3D digital noise reduction

Backlight Compensation: Support

AUDIO

Microphone: Stereo

SUPPORTED VIDEO FORMAT

Color System Compression: YUY2 / H.264 / MJPEG

Max. Resolution Video: 1080p@30fps/25fps,
720p@30fps/25fps,
960x540p@30fps/25fps,
640x360p@30fps/25fps

CONNECTIVITY

USB: 2.0

DIMENSIONS

Physical (W xH xD): 118 x 37.2 x 30.8 mm , (4.7 x 1.5x
1.2 inches)

Packaging (W xH x D): 143 x 76 x 76 mm , (5.63 x 3.0 x
3.0 inches)

WEIGHT

Physical (Net): 0.093 kg, (0.2 lb),

Packaging (Gross): 0.2 Kg, (0.44 lb)

REGULATIONS

Compliance Certification: USA &Canada: FCC, Europe: CE
RoHS, ErP

PACKAGE CONTENTS

1. VB-CAM-001, 2. Quick Start Guide, 3. Mounted screw, 4. USB 2.0
cable 5 feet (1.5m)

REPORT OF THE POLICE SERVICE

CKPSB REGULAR

ITEM #

4.4

TO

THE CHATHAM-KENT POLICE SERVICES BOARD

Board Report Number: 4.4 (Regular)
Date of Report: April 7, 2021
Date of Board Meeting: April 20, 2021
Reference: Board Citation – Constable Max Bossence
Recommendation: Receive the report for information purposes.

Overview:

On March 9th, 2021, at approximately 3:55 am, a 911 call came in from a location on Thomas Avenue in Wallaceburg of a stabbing. Constable Max Bossence was the first to arrive at this call and after speaking to one of the identified victims, who was not injured, learned that there was another victim in a nearby apartment. As he made his way there, he observed fresh blood leading to the apartment in question. Constable Bossence entered the apartment and observed the victim, in distress. Both of the victim's shirt and sheets were saturated in blood. He observed a stab wound to his bicep that was not bleeding, however when he pulled up his shirt, he observed a stab wound to his right chest/rib area with a large amount of blood coming from it. From his previous experience as a paramedic, Constable Bossence immediately identified this wound as a "sucking chest wound" and instantly knew that it was life threatening. He immediately grabbed a shirt and applied pressure to the wound. While doing so, he kept the victim talking, getting important information about the incident until EMS arrived and took over lifesaving efforts. Constable Bossence attended the hospital with the victim and it was confirmed that he indeed suffered a sucking chest wound.

On March 13th, 2021, correspondence was received from Chatham-Kent EMS General Manager, Donald MacLellan that Constable Bossence quick actions saved the victims life.

As a result of your courageous, quick thinking and lifesaving measures, you undoubtedly saved the man's life. I have recommended that you receive a CITATION from the Police Services Board.

Prepared by:

Chief Gary Conn



Chatham-Kent Police Service

24 Third Street • P.O. Box 366 • Chatham, Ontario • N7M 5K5

Tel: 519 436-6600

www.ckpolice.com

Fax: 519 436-6643

Gary Conn • Chief of Police

RECOMMENDATION FOR BOARD CITATION

Recipient: Constable Bossence

RE: Life Saving Actions

On March 9th, 2021, at approximately 3:55 am, a 911 call came in from a location on Thomas Avenue in Wallaceburg of a stabbing. Constable Max Bossence was the first to arrive at this call and after speaking to one of the identified victims, who was not injured, learned that there was another victim in a nearby apartment. As he made his way there, he observed fresh blood leading to the apartment in question. Constable Bossence entered the apartment and observed the victim, in distress. Both of the victim's shirt and sheets were saturated in blood. He observed a stab wound to his bicep that was not bleeding, however when he pulled up his shirt, he observed a stab wound to his right chest/rib area with a large amount of blood coming from it. From his previous experience as a paramedic, Constable Bossence immediately identified this wound as a "sucking chest wound" and instantly knew that it was life threatening. He immediately grabbed a shirt and applied pressure to the wound. While doing so, he kept the victim talking, getting important information about the incident until EMS arrived and took over lifesaving efforts. Constable Bossence attended the hospital with the victim and it was confirmed that he indeed suffered a sucking chest wound.

On March 13th, 2021, correspondence was received from Chatham-Kent EMS General Manager, Donald MacLellan that Constable Bossence quick actions saved the victims life.

As a result of your courageous, quick thinking and lifesaving measures, you undoubtedly saved the man's life. I have recommended that you receive a CITATION from the Police Services Board. The award will be presented to you at the next regular meeting of the Police Services Board to be held on Tuesday April 20, 2021 at 10:00 am at the Chatham-Kent Police Headquarters, 24 Third Street, Chatham. Please RSVP to Ms. Emily Murphy at 519-436-6603, at your earliest convenience.

Congratulations on a stellar job and I look forward to seeing you or (virtually see you) then!

Sincerely,

Gary Conn
Chief of Police

REPORT OF THE POLICE SERVICE**TO****THE CHATHAM-KENT POLICE SERVICES BOARD**

Board Report Number: 4.5 (Regular)

Date of Report: April 8, 2021

Date of Board Meeting: April 20, 2021

Reference: Approval of Vendor #210433 (Brian French)

Recommendation: Receive the report for approval to pay outstanding invoices and continue utilizing the Vendor

The Chatham-Kent Police are requesting retroactive permission for previous Invoices paid to vendor #210433 and future permission to continue utilizing the vendor's graphic design services. The vendor in question is Mr. Brian French, who is a full-time employee of the CKPS. Mr. French has been assisting with the Strategic Plans and Annual Reports for the past 12 years. At the time, staff were not aware that Section 39 (d) of the Purchasing By-law applied. To ensure we comply with the Municipal By-law, Purchasing Officer, Jennifer Scherle, recommended that the CKPSB approve this agreement with Mr. French.

Prepared by:

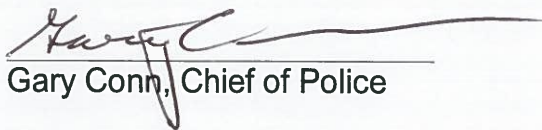

Gary Conn, Chief of Police

**REPORT OF THE POLICE SERVICE
TO
THE CHATHAM-KENT POLICE SERVICES BOARD**

Board Report Number: 5.1 (Regular)

Date of Report: March 12, 2021

Date of Board Meeting: April 20, 2021

Reference: Deputy Chief's Letter of Recognition

Recommendations: Receive and Acknowledge the Recognition

Possession of Stolen Property and Drug Seizure CK21010350

On Tuesday March 09 while on routine patrol in the city of Chatham, Constable HAMM and BLACKBURN observed suspected stolen property in the driveway at a residence known to be associated to criminal activity. The officers confirmed the Kubota tractor they observed on the property was stolen from the Sarnia area. Officers contacted the Intelligence Office for assistance. The scene was secured and officers believed that a significant amount of stolen property may be located on the property and due to the complexity of the investigation, the CKPS Intelligence Unit took over the investigation.

A Criminal Code Search Warrant was subsequently obtained and executed by the CKPS Intelligence Unit. During the search of the property, officers seized approximately \$80,000 in stolen property, namely; Kubota tractor, Honda ATV, 2 utility trailers, Kodiak generator and several Matco tools. Officers also seized approximately \$18,000 in illegal drugs; Fentanyl, Meth, Cocaine-28.89, Xanax, Adderall, Oxycodone, Ecstasy and several unmarked cigarettes. The accused was arrested and charged with numerous Criminal Code offences.

This investigation highlights the value of good and timely communication and great teamwork. The combination of interagency information sharing, persistent and focused patrol officers and a highly knowledgeable and experienced Intelligence Unit, all led to the swift identification and arrest of an active and prolific criminal.

Constables Jason Hamm, Jason Blackburn, Meredith Rota, Jeff Teetzel, Shawn Hoskins, Robert McNear, Greg Dilliot, Adrian Roy and Sergeant John Deforest are to be commended for their teamwork, attention to detail and their overall commitment to the safety and protection of our community.

Prepared by:



Deputy Chief Kirk Earley

Recommended by:



Chief Gary Conn

Larissa Jackson

From: message@maddmessage.ca
Sent: March 12, 2021 10:51 AM
To: Larissa Jackson
Subject: MADD Message Support Continuance

Dear Larissa

Thanks for taking time this morning regarding our appeal for supportive representation in the upcoming edition of MADD Message Yearbook. The placement last year, as in years previous, was the Honour Roll listing of three lines - Chatham-Kent Police Service, website address, and main phone number - price remains \$169. for the year. Continuing to be visible this year would once again demonstrate support for stopping impaired driving while publicly promoting commitment to the cause and helping to back important programs and services such as critical educational seminars in schools for new, young drivers. Without the backing of those able to be represented this important publication and the support it provides would not be possible. For additional information, to see our rates, and to see a recent e-copy, please visit our website, www.maddmessage.ca . Response by reply email or by calling 1-866-767-1736 would be appreciated. We hope to once again count on your participation in our upcoming edition.

Yours Truly,
Ken Campbell
T: (866) 767-1736
E: message@maddmessage.ca
W: www.maddmessage.ca

madd[★]

Saving Lives, Supporting Victims

Dear Prospective Advertiser,

On behalf of the Board of Directors, Members and Volunteers of MADD Canada, I would like to thank you for your interest in The MADD Message Yearbook.

The generosity of community-minded people like you makes it possible for MADD Canada to pursue its much-needed programs including victim support services, educational programs, youth programs and public awareness programs.

By placing an advertisement, you will be helping us in our mission *to stop impaired driving and to support victims of this violent crime*. The magazine will enable us to spread our life-saving messages even further and bring in additional revenues for our programs.

Every day in Canada, on average 4 people are killed and another 175 people are injured as a result of alcohol and drug-related crashes. You can help make all the difference in our efforts to save lives.

Thank you once again for your interest and support.

Sincerely,



Dawn Regan
Chief Operating Officer
MADD Canada